

udaberrian

NOIZ?	MARTXOAN ETA APIRILEAN
NOLA?	TRANPAK JARRIZ EDABEAREKIN
NON?	ERREKA ONDOAN IAZKO HABI BATEN HURBIL FRUTA-ARBOLETAN ZUHAIKIETAN...
15 EGUNIK BEHIN EDABEA ALDATU ETA TRANPA GARBITZEN DA.	



Edabea

Lata bat garagardo beltz.

+

Txikito bat ardo zuri

+

Goilarakada bat ahabi zuku

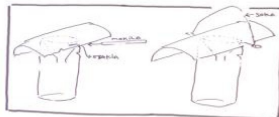
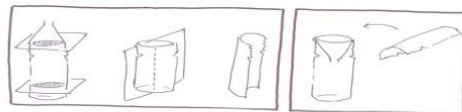
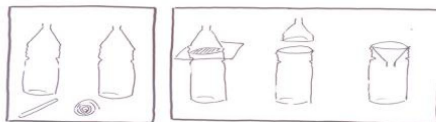

*Basako
Erlaxainen Alkartea*

Asociación de Apicultores
de Vizcaya

noiz jarri tranpak? martxotik maitzera arte

JARDUERA EGUTEGIA												
JARDUERAK	URT.	OTS.	MAR.	API.	MAI.	EKA.	UZT.	ABU.	IRA.	URR.	AZA.	ABE.
Erreginen tranpak jarri												
Langileen tranpak jarri												

The table displays a work schedule for two types of work: 'Erreginen tranpak jarri' (green) and 'Langileen tranpak jarri' (blue). The months are listed in the header: URT. (Feb), OTS. (Mar), MAR. (Apr), API. (May), MAI. (Jun), EKA. (Jul), UZT. (Aug), ABU. (Sep), IRA. (Oct), URR. (Nov), AZA. (Dec), and ABE. (Jan). The 'Erreginen tranpak jarri' row shows work from the second half of February through the first half of April, with a red circle around this period. The 'Langileen tranpak jarri' row shows work from the second half of May through the first half of August.